

# WARING COMMERCIAL

## Europe **TORq** 2.0 Blender

with 2 Toggle Switches and  
64 oz. Stainless Steel Container

### TBB145S6E

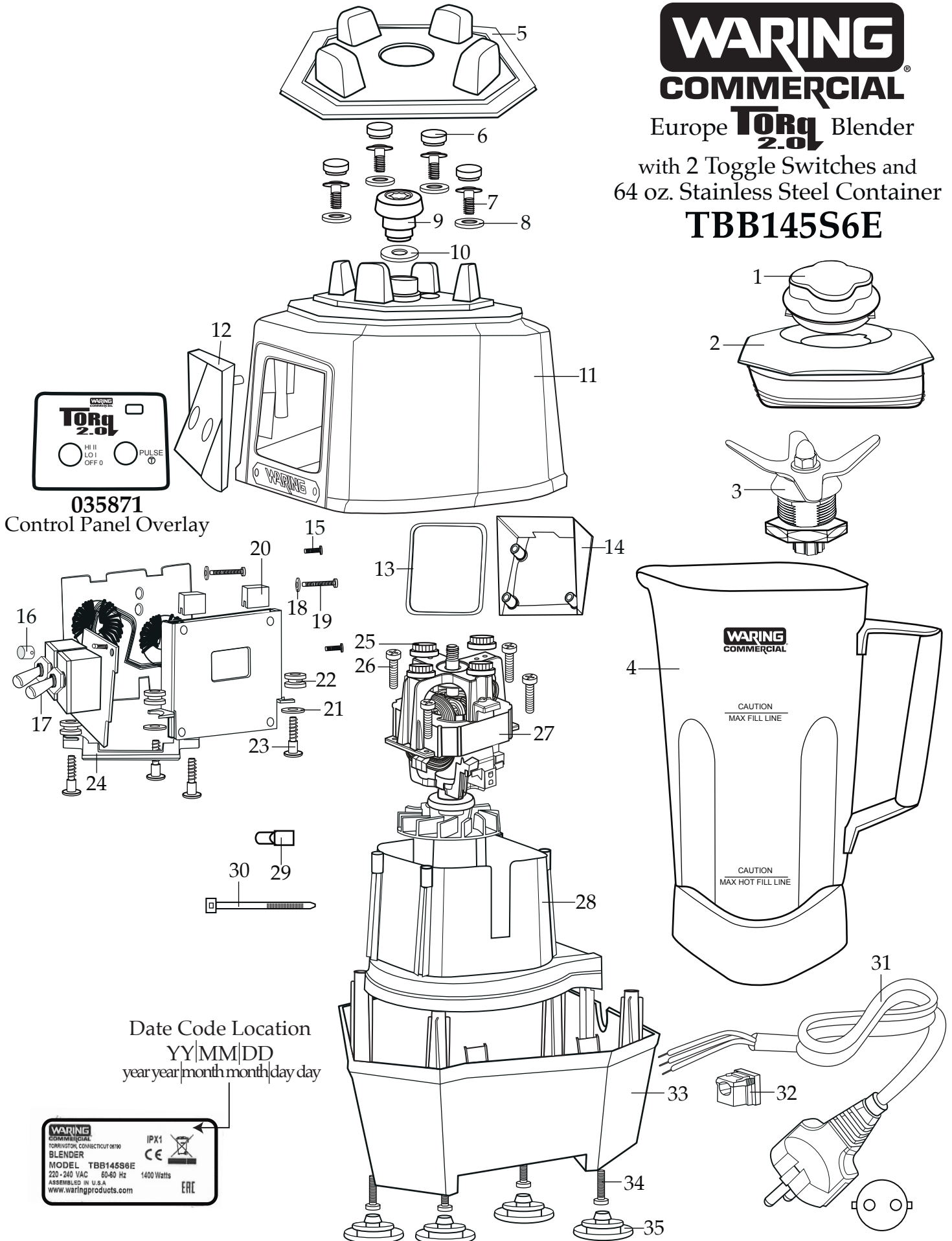

**035871**

Control Panel Overlay

Date Code Location  
YY|MM|DD  
year|year|month|month|day|day

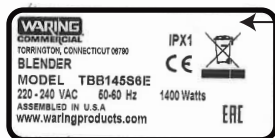

Illustration#	Part#	Description
1	026425-E	Eastman Jar Lid Cover
2	026424-V	Vinyl Jar Lid
3	031060	Blending Assembly Kit
4	026648 503346	64 oz. Stainless Steel Container ONLY 64 oz. Stainless Steel Container Co
5	035885 035091	Jar Pad ( <i>changed after 7/6/2018</i> ) Jar Pad (use 035885)
6	035085	Hole Plug (4 required)
7	034275	Sems (4 required)
8	034273	B Gasket (4 required)
9	037034 035251	Drive Goupling ( <i>on units after 11/15/2019</i> ) Drive Coupling
10	037033	Coupling Washer ( <i>on units after 11/15/2019</i> )
11	503609 503460-145-E	Top Housing Assembly with Badge ( <i>on units after 9/28/2022</i> ) Top Housing Assembly
12	035080	Control Housing Front Bezel ( <i>on units after 9/28/2022</i> )
13	038576	Housing Control Seal ( <i>on units after 9/28/2022</i> )
14	035083	Back Bezel ( <i>on units after 9/28/2022</i> )
15	035090	Screw (2 required)
16	035253	LED Lens
17	035163	TBB145 230 volt Control Panel Assembly
18	035255	Washer (2 required)
19	035089	Screw (2 required)
20	034900	PCB Cushion (2 required)
21	013604	Washer (2 required)
22	034904	Rubber Grommet (4 required)
23	034902	Sems (4 required)
24	035894	Control Board Bracket
25	034272	A Gasket (4 required)
26	034274	Screw (4 required)
27	035816 035475	Chiaphua Motor No Sensor ( <i>on units after 2/26/2018</i> ) ECM Motor
28	503483	Motor Housing with Dampeners
29	012409 019123	Small Crimp Connectors (2 required) Large Crimp Connector (3 required)

Illustration#	Part#	Description
30	013731	Cable Ties (6 required)
31	017948	Cordset
32	033619	Strain Relief
33	503480 035079	Bottom Housing Assembly with Feet Bottom Housing
34	034274	Screw (4 required)
35	035088	Foot (4 required)

**Part No Longer Used**

(last used on 1/25/2021)

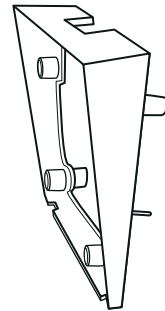

035083

Control Housing Back Bezel

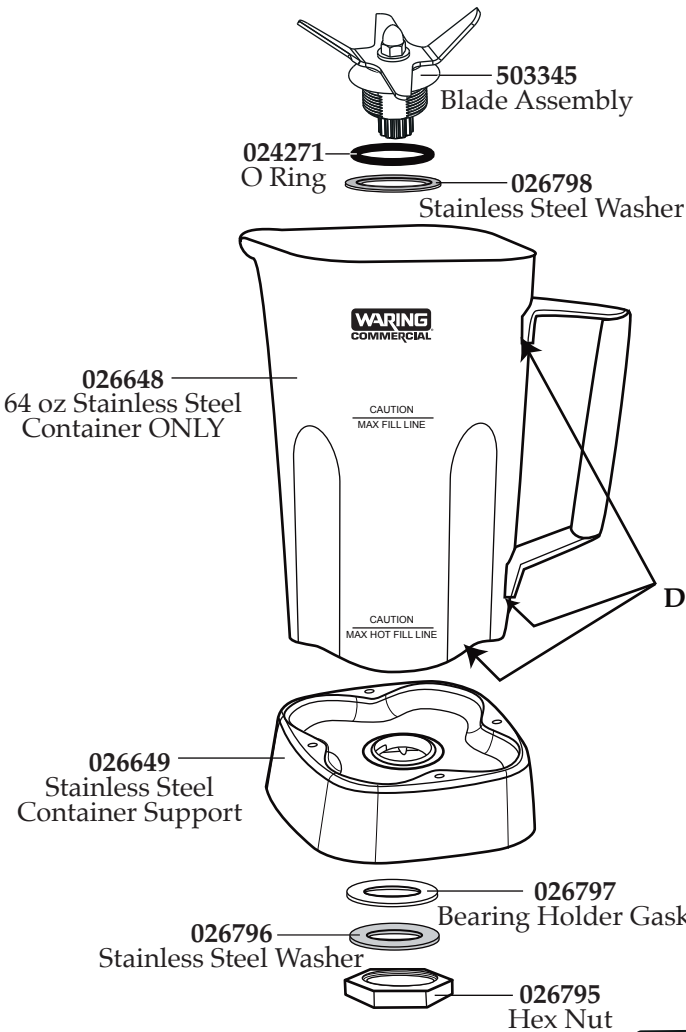

**Notes:**

Sealant applied all round these indicated areas.  
**Dow Corning Sealant RTV 733**  
Torque 100-125 in / lbs.  
Lubricant applied to O Ring  
**Dow Corning 200 (R) Fluid**

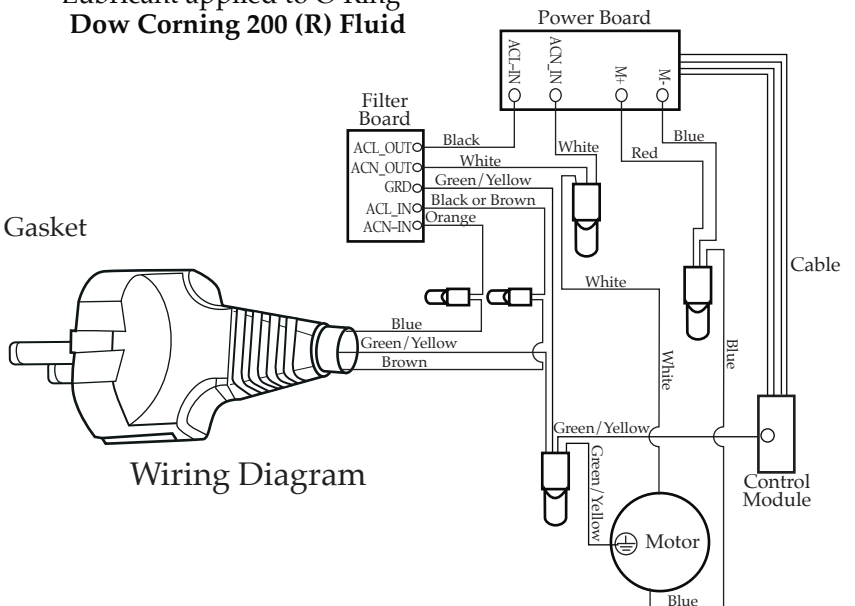

Wiring Diagram